

# VESP-30 2-RU Rack/Wall-Mount Surplus Fiber Spool Panel

**1. GENERAL**

**1.1 Document Purpose.** This document facilitates the installation of the Westell VESP-30, shown in Figure 1.

**1.2 Document Status.** Whenever this document is updated, the reason will be stated here.

**1.3 Product Purpose.** The VESP-30 is a 2 Rack Unit (2-RU) high, 3-spool, surplus fiber panel designed to safely store up surplus fiber cable.

**1.4 Product Mounting.** As shipped, the VESP-30 mounts in 2 Rack Units (2-RUs) of a 19" or 23" equipment rack. It also can be mounted on a wall (nylon spacers included).

**1.5 Product Features**

The VESP-30 offers the following features:

- 2-RUs high
- 3 Fiber spools for ample, safe, fiber cable storage
- Convenient rear cable tie-down brackets (6)
- Wall or rack-mountable in 19" or 23" equipment racks
- Nylon spacers, rack-mount screws, and 23" rack-mount brackets provided

**2. INSTALLATION**

Install the unit as described below. See Figure 3 and Figure 4.

1. **Unpack and inspect.** Gently unpack the unit and inspect it for damage (report damages to the shipping company and to Westell).
2. **Gather tools/supplies.** The following may be needed to mount and use the panel:
  - Screwdrivers (Phillips or blade-type)
  - Wall-mounting hardware (if wall-mounted)
  - Cable ties and/or cable management materials
3. **Attach brackets - 23" rack mounting only.** Attach the provided mounting brackets (shown in Figure 1). Each bracket has two threaded holes. Align these holes with two holes side edges of the panel, then insert a screw through each aligned hole set (through the panel and into the mounting bracket). Tighten the four screws. When brackets are secure, mount the panel in a 23" equipment rack, as shown in Figure 3A.
4. **Mount in rack - 19" and 23" rack mounting.** Lift the panel and place it against the rack in the desired location, aligning the holes in the panel (or mounting brackets) with the

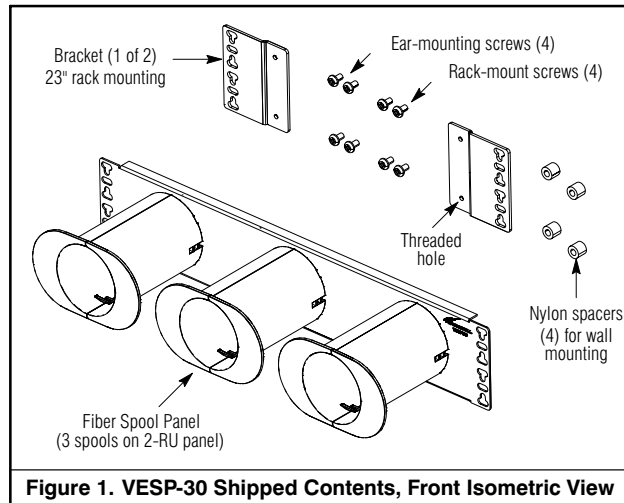

**Figure 1. VESP-30 Shipped Contents, Front Isometric View**

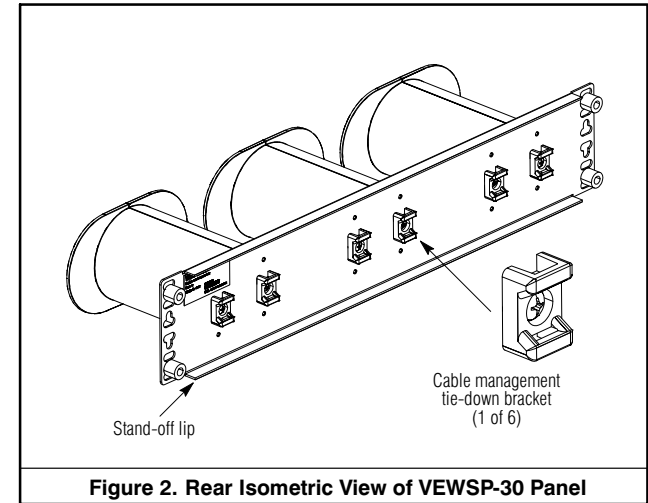

**Figure 2. Rear Isometric View of VESP-30 Panel**

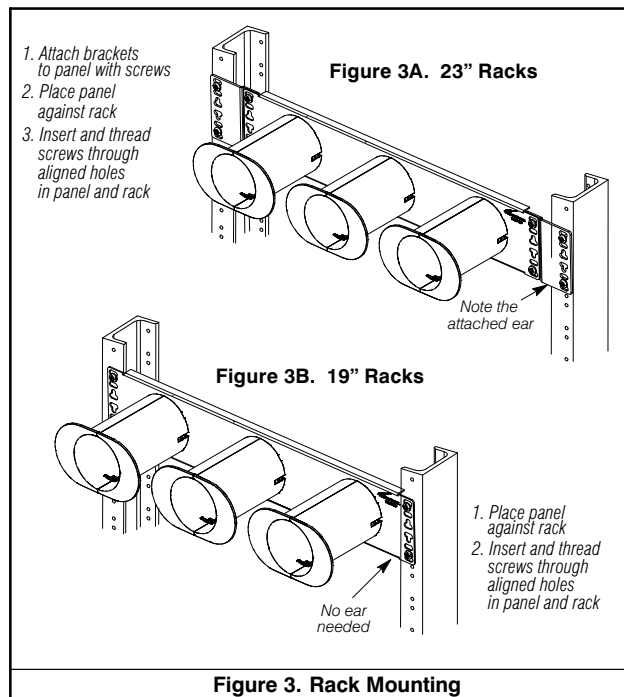

**Figure 3. Rack Mounting**

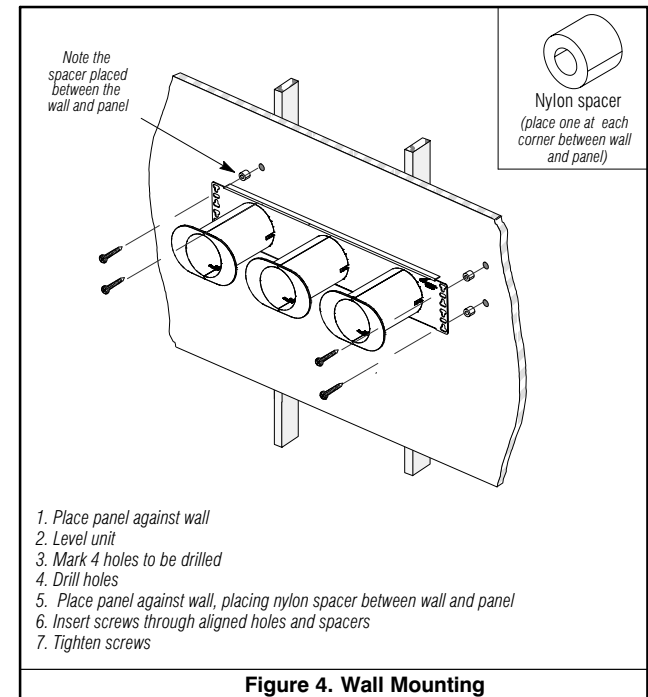

**Figure 4. Wall Mounting**

holes in the rack channel, then threading four screws into the rack channel through the aligned holes in the panel/bracket (2 screws per side/channel). Do not use the provided mounting brackets for 19" racks (Figure 3B).

**- ROUTING CABLES NOTE -**  
 When wall mounting is performed, route any cables behind the VESP-30 panel prior to mounting it on the wall, using the provided cable tie-downs at the rear of the panel as needed. Verify the cable diameter is less than the depth of the protective lip at the top and bottom of the panel.

5. **Wall-mounting only.** Place the panel against the wall in the desired mounting location, mark the locations for the mounting holes through the keyholes at each side of the panel, level the panel, then drill holes in the wall for the mounting screws (not provided). Lift the panel to the wall, align the holes in the panel with the holes in the wall, place a provided nylon spacer between the panel and wall in line with the holes, then insert and thread a mounting screw through aligned holes in the panel, spacer, and wall. Repeat for each corner/mounting hole. Tighten all screws.
6. **Route cable around spools.** Use the fiber spools at the front of the panel in any combination per company practice, to safely store the surplus fiber.
7. **Label spools/fiber.** Use labels or markers per company practice to label the fiber/cables on each spool.
8. Repeat above steps for each VESP-30 panel installed.

Part #	Description
A90-VESP30	2-RU, Rack/Wall-Mount Surplus Fiber Spool Panel.

**Table 1. Ordering Information**

**3. TESTING & TROUBLESHOOTING**

This equipment should not be field repaired. If trouble is encountered, verify all installer connections. If trouble persists, replace the suspect unit with another optioned identically, and retest. If the replacement unit operates correctly, the original unit may be faulty and should be returned for repair or replacement. Repairs made beyond replacing a faulty unit are not recommended and may void the warranty.

**4. CUSTOMER & TECHNICAL SERVICES**

**4.1 Customer Service & Technical Assistance.** If technical or customer assistance is required, contact Westell by calling or using one of the following options:

Voice: (630) 377-8766  
 email: [global\\_support@westell.com](mailto:global_support@westell.com)

Visit the Westell World Wide Web site at <http://www.Westell.com> for additional information about Westell.

**4.2 Part Numbers.** This equipment is identified by a product number (A90-VESP30), which consists of three parts: the issue letter of the equipment (A), the assembly type (90), and the specific model number (VESP30). Each time a change is made to the product which changes the form, fit, or function of the product, the issue letter is incremented or advanced by one. Be sure to indicate the issue level as well as the model number when making inquiries about the equipment.

**- TL9000 RECYCLING NOTE -**  
 Westell recommends that its products be recycled at the end of their product life. For Westell products that have reached their product End Of Life (EOL), please recycle and dispose of the products per your company practice, per local recycling programs and local codes, and per state statutes.

**5. WARRANTY & REPAIRS**

**5.1 Warranty.** Westell warrants this product to be defect free at shipment time, and warrants the product to be fully functional for the time period specified by the terms and conditions governing the product sale. Equipment repairs/modifications by unauthorized persons will void the warranty.

**5.2 Repair and Return.** Westell will repair or replace this unit without cost during the warranty period if the unit is defective for any reason other than abuse, improper use, or improper installation. To return defective equipment, first request a Return Material Authorization (RMA) number from Westell by calling or using one of the options shown below. Once an RMA number is obtained, return the defective unit (freight prepaid), along with a brief problem description, to the address we will provide to you when you contact us.

Voice: (630) 375-4457  
 email: [rgmdept@westell.com](mailto:rgmdept@westell.com)

Westell will continue to repair/replace faulty equipment beyond the warranty time for a nominal charge. Call Westell for details.

**- FIBER WARNINGS AND CAUTIONS -**

**Always follow proper fiber precautions whenever working with fiber.**

**Carefully clean up any shards and loose fiber pieces and avoid hand, skin, or eye contact with fiber shards.**

**Never look into the end of a live fiber strand and always wear protective eye wear.**

**Always observe proper fiber cable bend radius guidelines; never kink or excessively bend fibers.**

